

Soils Map

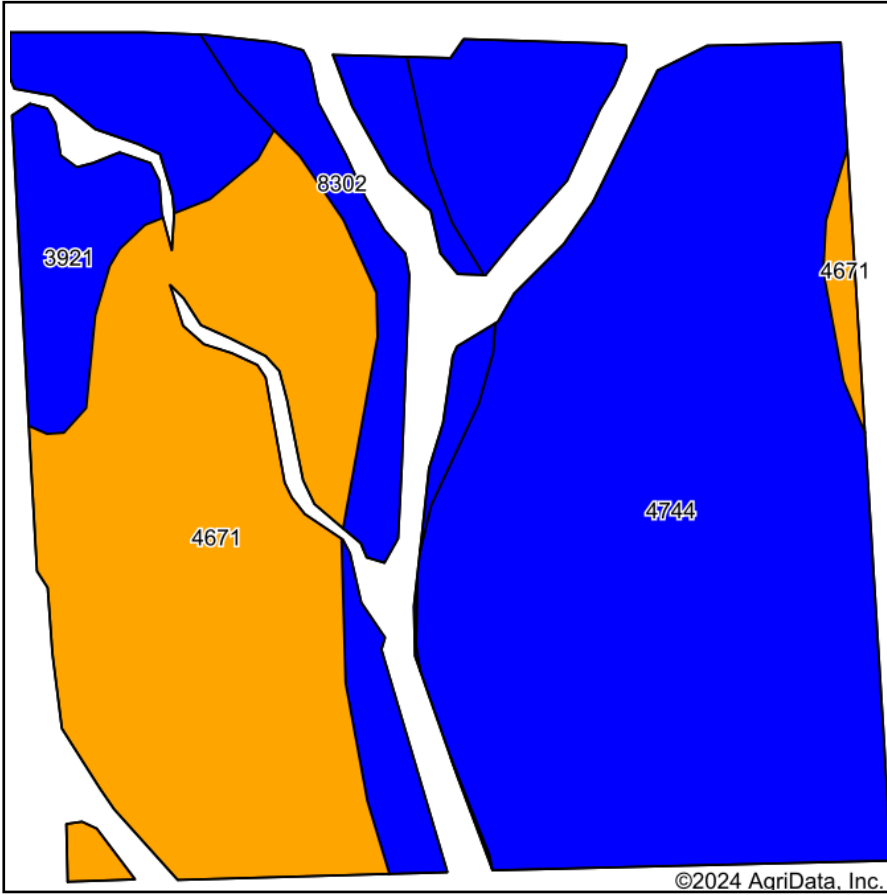

Soils data provided by USDA and NRCS.

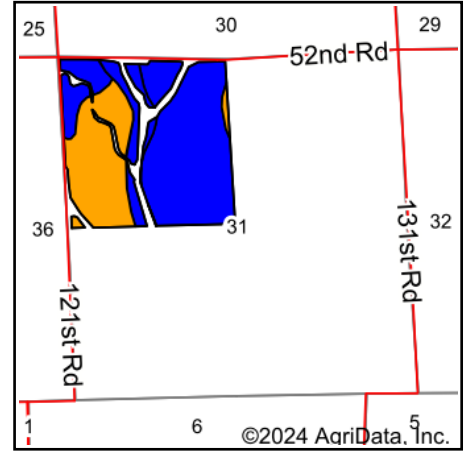

State: **Kansas**
 County: **Cowley**
 Location: **31-30S-5E**
 Township: **Richland**
 Acres: **134.03**
 Date: **6/10/2024**



Maps Provided By:



Area Symbol: KS035, Soil Area Version: 20

Code	Soil Description	Acres	Percent of field	Non-Irr Class Legend	Non-Irr Class *c	Irr Class *c	Range Production (lbs/acre/yr)	*n NCCPI Overall	*n NCCPI Corn	*n NCCPI Small Grains	*n NCCPI Soybeans	*n NCCPI Cotton
4744	Labette-Dwight complex, 0 to 3 percent slopes	69.66	52.0%		Ile	Ile	4135	47	34	47	41	28
4671	Irwin silty clay loam, 1 to 3 percent slopes	41.64	31.1%		IIIls	IIIls	3585	56	45	54	55	40
8302	Verdigris silt loam, 0 to 1 percent slopes, occasionally flooded	11.42	8.5%		IIw		7995	82	81	70	82	44
3921	Smolan silty clay loam, 1 to 3 percent slopes	11.31	8.4%		Ile	Ile	5030	68	68	64	66	48
Weighted Average					2.31	*-	4368.5	*n 54.6	*n 44.3	*n 52.6	*n 51	*n 34.8

*n: The aggregation method is "Weighted Average using all components"

*c: Using Capabilities Class Dominant Condition Aggregation Method

*- Irr Class weighted average cannot be calculated on the current soils data due to missing data.