

Soils Map

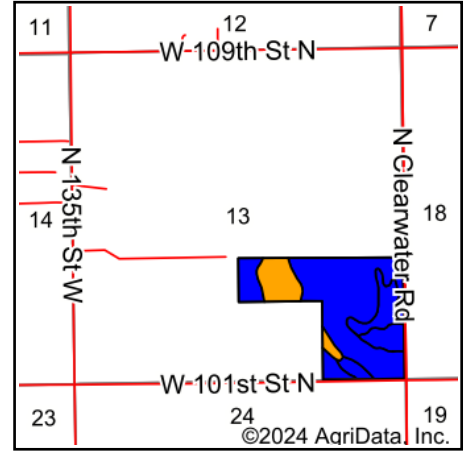

State: **Kansas**
 County: **Sedgwick**
 Location: **13-25S-2W**
 Township: **Eagle**
 Acres: **79.25**
 Date: **7/30/2024**

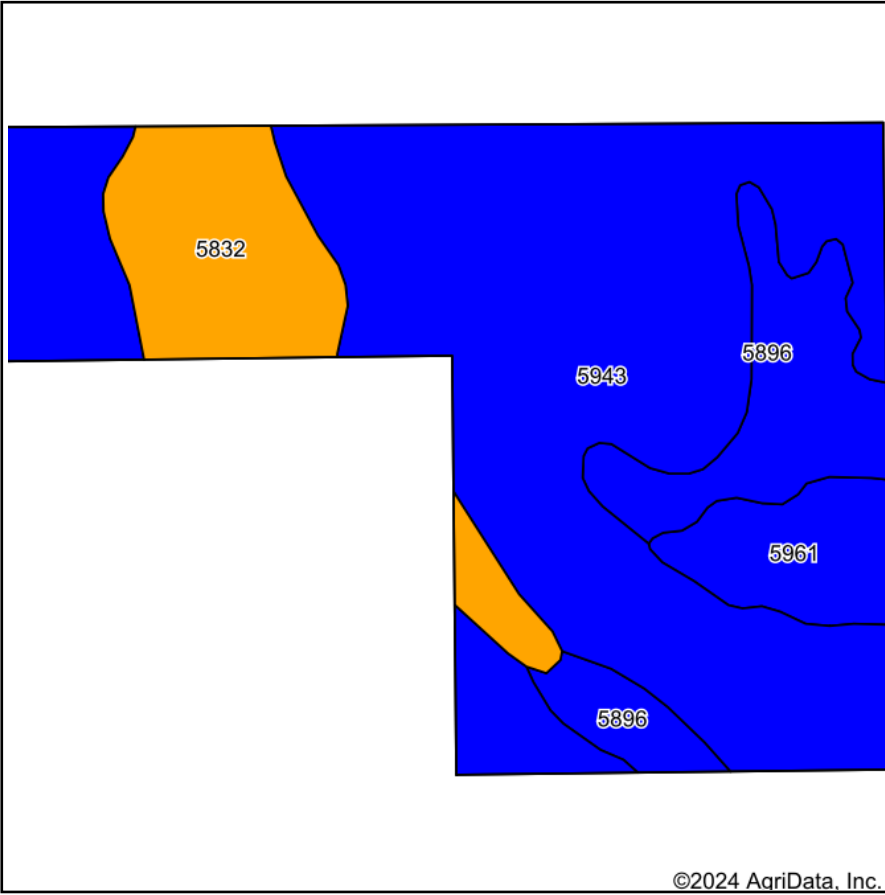

Soils data provided by USDA and NRCS.

Area Symbol: KS173, Soil Area Version: 19

Code	Soil Description	Acres	Percent of field	Non-Irr Class Legend	Non-Irr Class *c	Irr Class *c	Range Production (lbs/acre/yr)	*n NCCPI Overall	*n NCCPI Corn	*n NCCPI Small Grains	*n NCCPI Soybeans	*n NCCPI Cotton
5943	Saltcreek and Naron fine sandy loams, 0 to 1 percent slopes	52.62	66.3%		IIc	Iw	3040	57	44	49	57	22
5832	Punkin-Taver complex, 0 to 1 percent slopes	10.90	13.8%		IIIc	IIIc	2683	37	15	37	24	15
5896	Nalim-Shellabarger sandy loams, 0 to 1 percent slopes	10.53	13.3%		IIe	IIe	3260	59	48	51	59	33
5961	Solvay loamy fine sand, 0 to 2 percent slopes	5.20	6.6%		IIe	IIe	5750	50	49	45	50	32
Weighted Average					2.14	1.47	3197.9	*n 54.1	*n 40.9	*n 47.4	*n 52.3	*n 23.2

*n: The aggregation method is "Weighted Average using all components"

*c: Using Capabilities Class Dominant Condition Aggregation Method

Soils data provided by USDA and NRCS.