

Soils Map

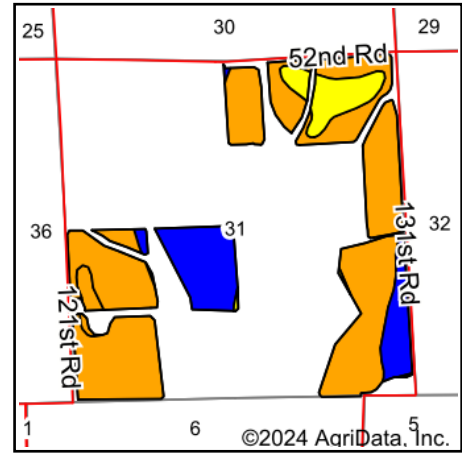

State: **Kansas**
 County: **Cowley**
 Location: **31-30S-5E**
 Township: **Richland**
 Acres: **231.93**
 Date: **6/10/2024**

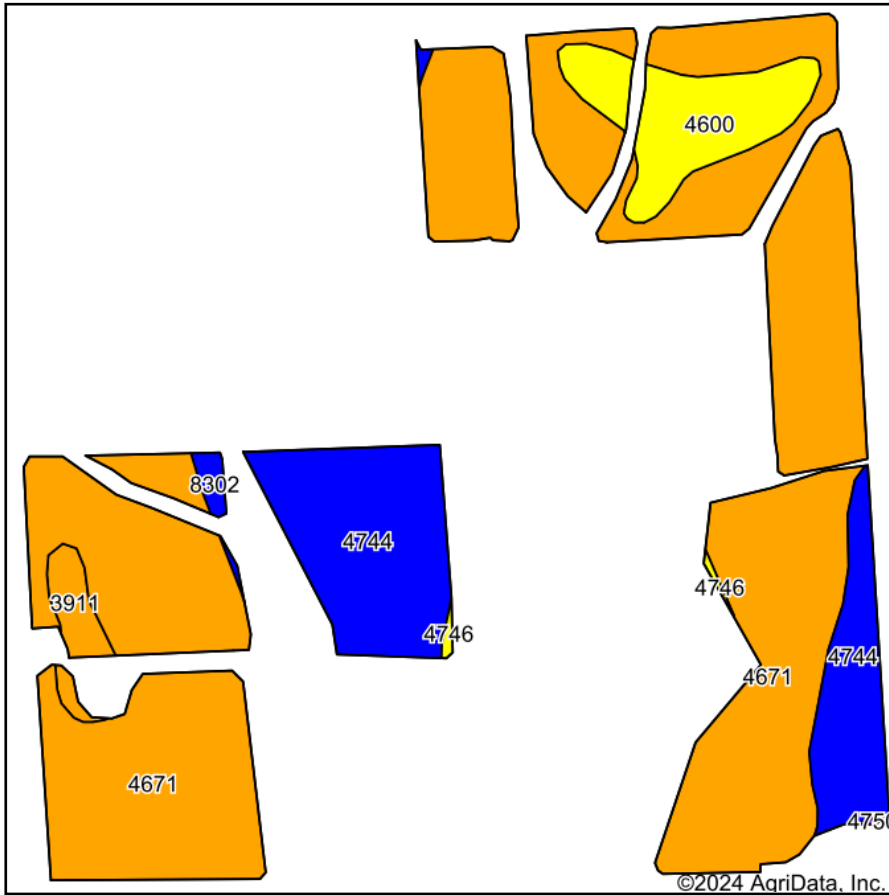

Soils data provided by USDA and NRCS.

Area Symbol: KS035, Soil Area Version: 20

Code	Soil Description	Acres	Percent of field	Non-Irr Class Legend	Non-Irr Class *c	Irr Class *c	Range Production (lbs/acre/yr)	*n NCCPI Overall	*n NCCPI Corn	*n NCCPI Small Grains	*n NCCPI Soybeans	*n NCCPI Cotton
4671	Irwin silty clay loam, 1 to 3 percent slopes	165.63	71.4%		III _s	III _s	3585	56	45	54	55	40
4744	Labette-Dwight complex, 0 to 3 percent slopes	41.85	18.0%		II _e	II _e	4135	47	34	47	41	28
4600	Dwight silt loam, 0 to 1 percent slopes	17.77	7.7%		IV _s	IV _s	3160	41	21	40	33	26
3911	Rosehill silty clay, 1 to 3 percent slopes	4.53	2.0%		III _e	III _e	3550	44	30	44	42	19
8302	Verdigris silt loam, 0 to 1 percent slopes, occasionally flooded	1.46	0.6%		II _w		7995	82	81	70	82	44
4746	Labette-Sogn silty clay loam, 0 to 8 percent slopes	0.57	0.2%		IV _e	III _e	3705	37	32	37	33	19
4750	Sogn silty clay loam, 0 to 10 percent slopes	0.12	0.1%		VI _s		2655	22	20	22	17	9
Weighted Average					2.89	*-	3678.6	*n 53.1	*n 41.1	*n 51.5	*n 50.6	*n 36.3

*n: The aggregation method is "Weighted Average using all components"

*c: Using Capabilities Class Dominant Condition Aggregation Method

*-: Irr Class weighted average cannot be calculated on the current soils data due to missing data.