

Soils Map

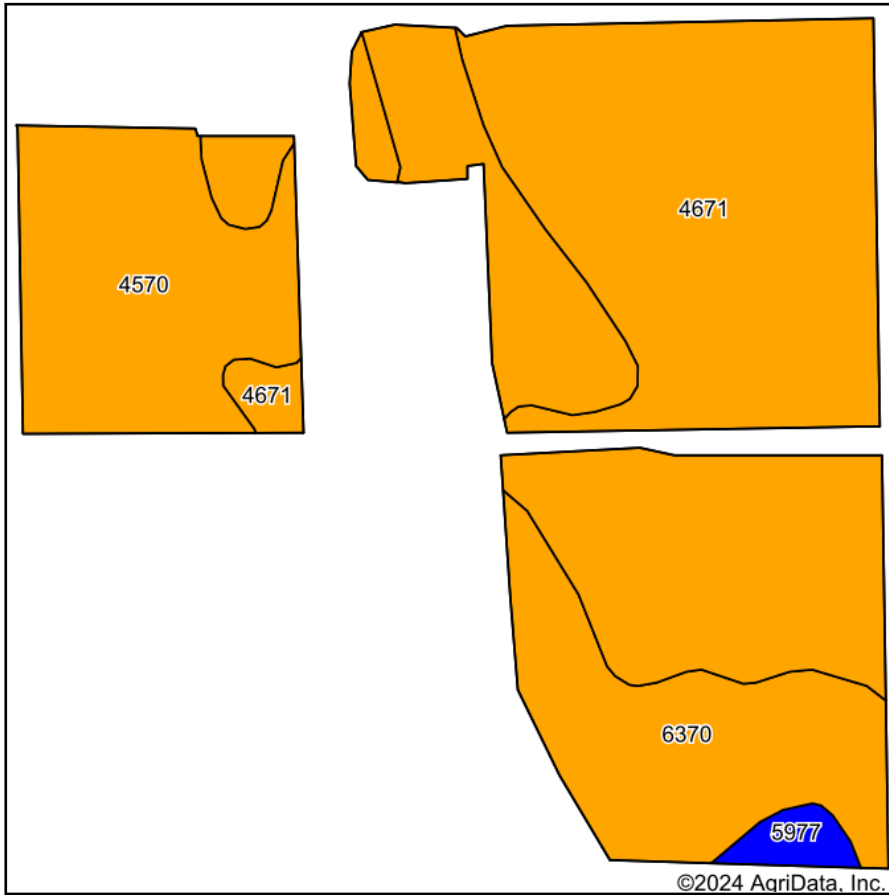

Soils data provided by USDA and NRCS.

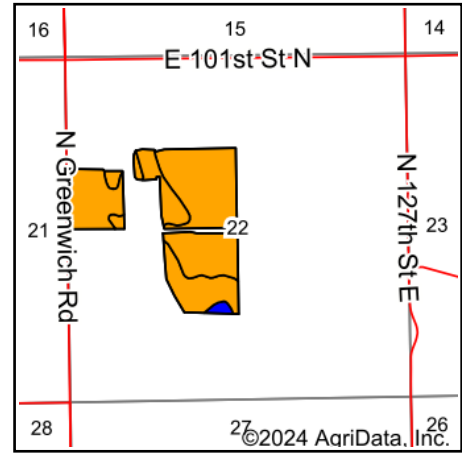

State: **Kansas**
 County: **Sedgwick**
 Location: **22-25S-2E**
 Township: **Lincoln**
 Acres: **85.1**
 Date: **10/14/2024**



Area Symbol: KS173, Soil Area Version: 19

Code	Soil Description	Acres	Percent of field	Non-Irr Class Legend	Non-Irr Class *c	Irr Class *c	Range Production (lbs/acre/yr)	Corn Irrigated Bu	Grain sorghum Bu	Grain sorghum Irrigated Bu	Smooth bromegrass AUM	Smooth bromegrass Irrigated AUM	Winter wheat Bu	*n NCCPI Overall	*n NCCPI Corn
4671	Irwin silty clay loam, 1 to 3 percent slopes	47.07	55.3%		III s	III s	3585							56	49
4570	Clime silty clay, 3 to 7 percent slopes	23.05	27.1%		III e	III e	3570							42	38
6370	Milan loam, 3 to 6 percent slopes	13.74	16.1%		III e		4020	149	52	109	5	10	32	65	62
5977	Vanoss silt loam, 1 to 3 percent slopes	1.24	1.5%		II e	II e	4931							72	70
Weighted Average					2.99	*-	3670.8	24.1	8.4	17.6	0.8	1.6	5.2	*n 53.9	*n 45.4

*n: The aggregation method is "Weighted Average using all components"

*c: Using Capabilities Class Dominant Condition Aggregation Method

*- Irr Class weighted average cannot be calculated on the current soils data due to missing data.

Soils data provided by USDA and NRCS.