

Soils Map

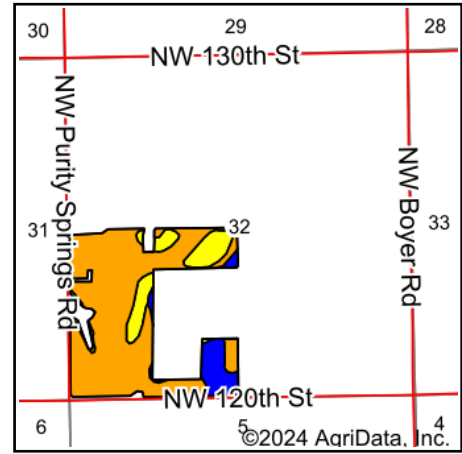

Soils data provided by USDA and NRCS.



State: **Kansas**
 County: **Butler**
 Location: **32-23S-5E**
 Township: **Lincoln**
 Acres: **102.98**
 Date: **9/30/2024**



Area Symbol: KS015, Soil Area Version: 21

Code	Soil Description	Acres	Percent of field	Non-Irr Class Legend	Non-Irr Class *c	Irr Class *c	Range Production (lbs/acre/yr)	*n NCCPI Overall	*n NCCPI Corn	*n NCCPI Small Grains	*n NCCPI Soybeans	*n NCCPI Cotton
4671	Irwin silty clay loam, 1 to 3 percent slopes	78.01	75.8%		IIIs	IIIs	3585	56	45	54	55	40
4674	Irwin silty clay loam, 3 to 7 percent slopes, eroded	13.81	13.4%		IVe	IVe	3598	50	43	50	49	38
4740	Labette silty clay loam, 1 to 3 percent slopes	10.00	9.7%		Ile	Ile	4710	47	40	47	43	27
4673	Irwin silty clay loam, 3 to 7 percent slopes	0.95	0.9%		IVe	IVe	3550	57	48	57	57	40
4746	Labette-Sogn silty clay loam, 0 to 8 percent slopes	0.21	0.2%		IVe	IIIe	3705	37	32	37	33	19
Weighted Average					3.05	3.05	3695.9	*n 54.3	*n 44.2	*n 52.8	*n 53	*n 38.4

*n: The aggregation method is "Weighted Average using all components"

*c: Using Capabilities Class Dominant Condition Aggregation Method