

Soils Map

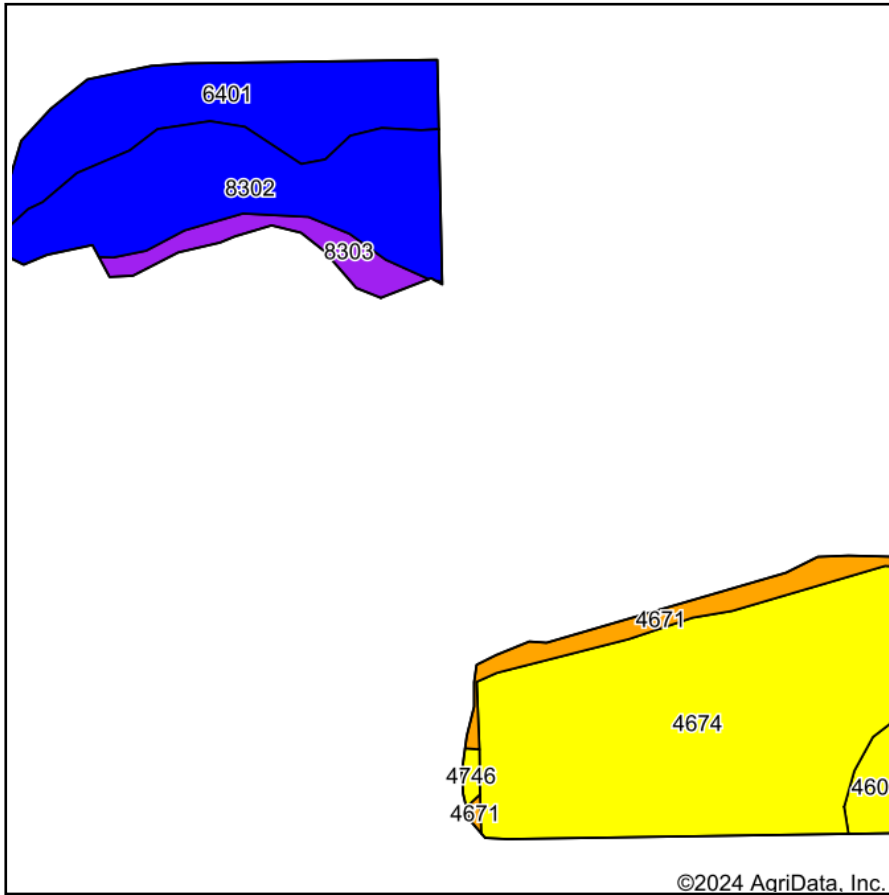

Soils data provided by USDA and NRCS.

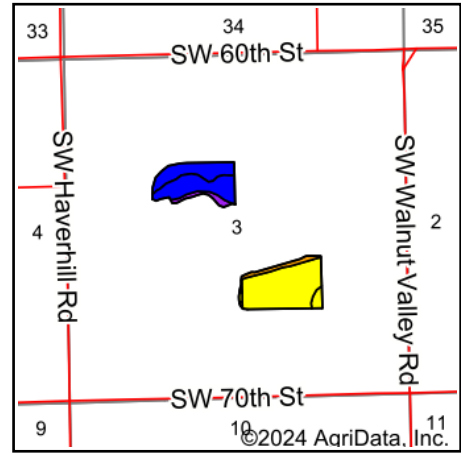

State: **Kansas**
 County: **Butler**
 Location: **3-27S-5E**
 Township: **Spring**
 Acres: **35.32**
 Date: **10/14/2024**



Area Symbol: KS015, Soil Area Version: 21												
Code	Soil Description	Acres	Percent of field	Non-Irr Class Legend	Non-Irr Class *c	Irr Class *c	Range Production (lbs/acre/yr)	*n NCCPI Overall	*n NCCPI Corn	*n NCCPI Small Grains	*n NCCPI Soybeans	*n NCCPI Cotton
4674	Irwin silty clay loam, 3 to 7 percent slopes, eroded	16.71	47.2%		IVe	IVe	3598	50	43	50	49	38
8302	Verdigris silt loam, 0 to 1 percent slopes, occasionally flooded	7.79	22.1%		IIw		7995	82	81	70	82	44
6401	Norge silt loam, 1 to 3 percent slopes	6.39	18.1%		IIe	IIe	4920	76	72	69	76	36
4671	Irwin silty clay loam, 1 to 3 percent slopes	1.79	5.1%		IIIs	IIIs	3585	56	45	54	55	40
8303	Verdigris soils, frequently flooded	1.47	4.2%		Vw		7725	61	61	51	56	14
4600	Dwight silt loam, 0 to 1 percent slopes	1.00	2.8%		IVs	IVs	3160	41	21	40	33	26
4746	Labette-Sogn silty clay loam, 0 to 8 percent slopes	0.17	0.5%		IVe	IIIe	3705	37	32	37	33	19
Weighted Average					3.19	*-	4966.2	*n 62.2	*n 56.8	*n 57.7	*n 61.2	*n 37.6

*n: The aggregation method is "Weighted Average using all components"

*c: Using Capabilities Class Dominant Condition Aggregation Method

*-: Irr Class weighted average cannot be calculated on the current soils data due to missing data.