

# Soils Map

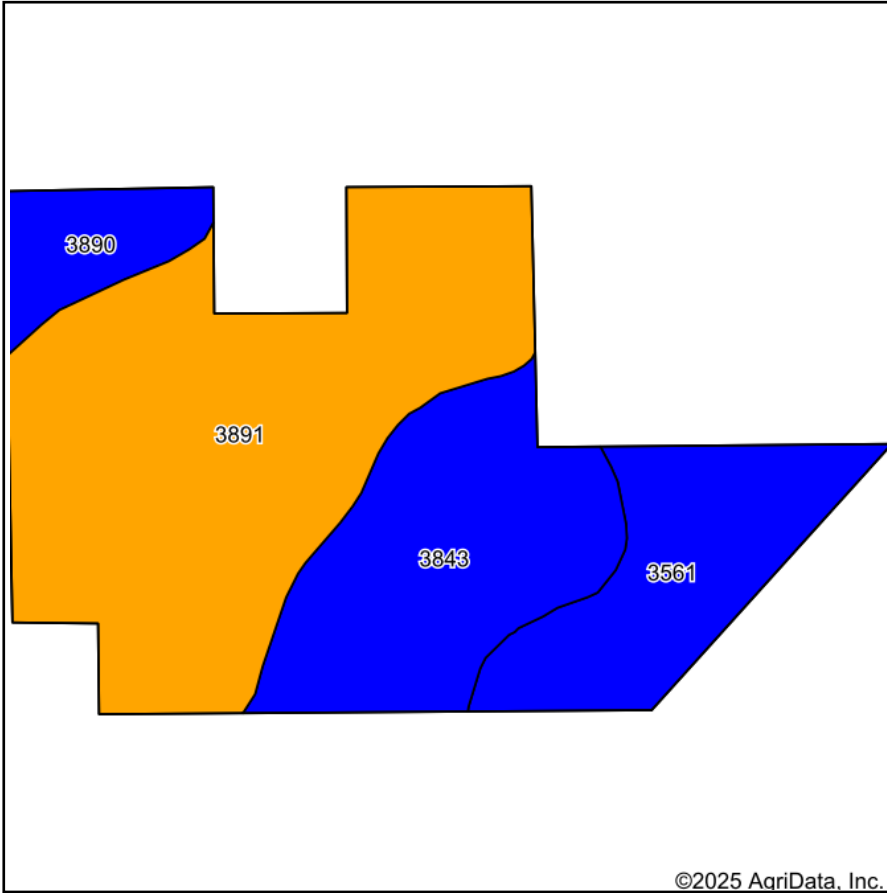

Soils data provided by USDA and NRCS.

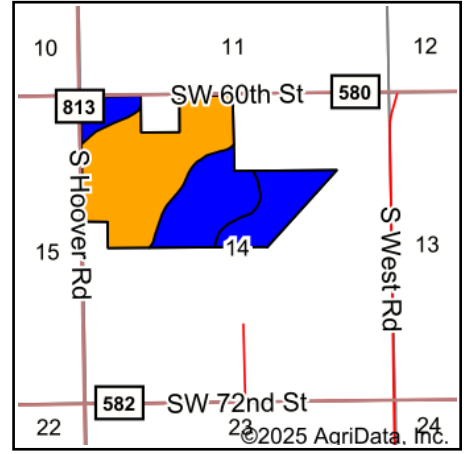

State: **Kansas**  
 County: **Harvey**  
 Location: **14-24S-1W**  
 Township: **Sedgwick**  
 Acres: **178.18**  
 Date: **1/21/2025**



Area Symbol: KS079, Soil Area Version: 21

Code	Soil Description	Acres	Percent of field	Non-Irr Class Legend	Non-Irr Class *c	Irr Class *c	Range Production (lbs/acre/yr)	*n NCCPI Overall	*n NCCPI Corn	*n NCCPI Small Grains	*n NCCPI Soybeans	*n NCCPI Cotton
3891	Ladysmith silty clay loam, 1 to 3 percent slopes	91.73	51.5%		III s	III s	3525	53	39	52	51	28
3843	Geary silt loam, 1 to 3 percent slopes	44.03	24.7%		II e	II e	4040	71	68	65	71	36
3561	Hobbs silt loam, occasionally flooded	30.64	17.2%		II w	II w	5845	79	68	61	79	37
3890	Ladysmith silty clay loam, 0 to 1 percent slopes	11.78	6.6%		II s	II s	3525	53	39	52	52	28
<b>Weighted Average</b>					<b>2.51</b>	<b>2.51</b>	<b>4051.2</b>	<b>*n 61.9</b>	<b>*n 51.2</b>	<b>*n 56.8</b>	<b>*n 60.8</b>	<b>*n 31.5</b>

\*n: The aggregation method is "Weighted Average using all components"

\*c: Using Capabilities Class Dominant Condition Aggregation Method

Soils data provided by USDA and NRCS.