

Soils Map

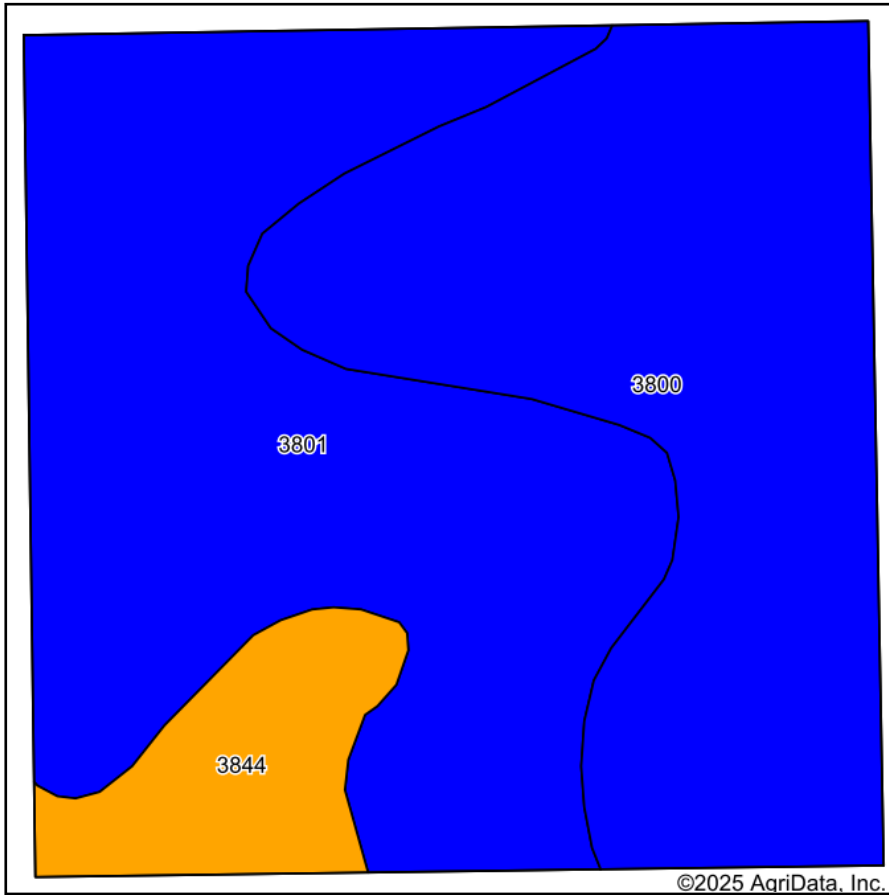

Soils data provided by USDA and NRCS.

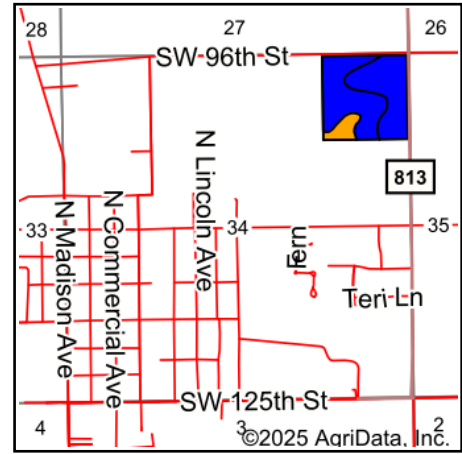

State: **Kansas**
 County: **Harvey**
 Location: **34-24S-1W**
 Township: **Sedgwick**
 Acres: **38.26**
 Date: **2/26/2025**



Area Symbol: KS079, Soil Area Version: 21

Code	Soil Description	Acres	Percent of field	Non-Irr Class Legend	Non-Irr Class *c	Irr Class *c	Range Production (lbs/acre/yr)	*n NCCPI Overall	*n NCCPI Corn	*n NCCPI Small Grains	*n NCCPI Soybeans	*n NCCPI Cotton
3801	Crete silt loam, 1 to 3 percent slopes, loess plains and breaks	18.63	48.7%		Ile	Ile	3650	64	55	60	64	37
3800	Crete silt loam, 0 to 1 percent slopes, loess plains and breaks	16.40	42.9%		Ils	Ils	3580	65	57	61	65	37
3844	Geary silt loam, 3 to 7 percent slopes	3.23	8.4%		Ille	Ille	4085	71	68	65	71	36
Weighted Average					2.08	2.08	3656.7	*n 65	*n 57	*n 60.9	*n 65	*n 36.9

*n: The aggregation method is "Weighted Average using all components"

*c: Using Capabilities Class Dominant Condition Aggregation Method