

# Soils Map

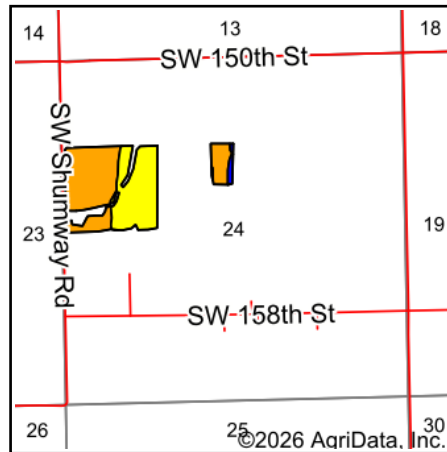

State: **Kansas**  
 County: **Butler**  
 Location: **24-28S-4E**  
 Township: **Walnut**  
 Acres: **42.67**  
 Date: **4/13/2026**

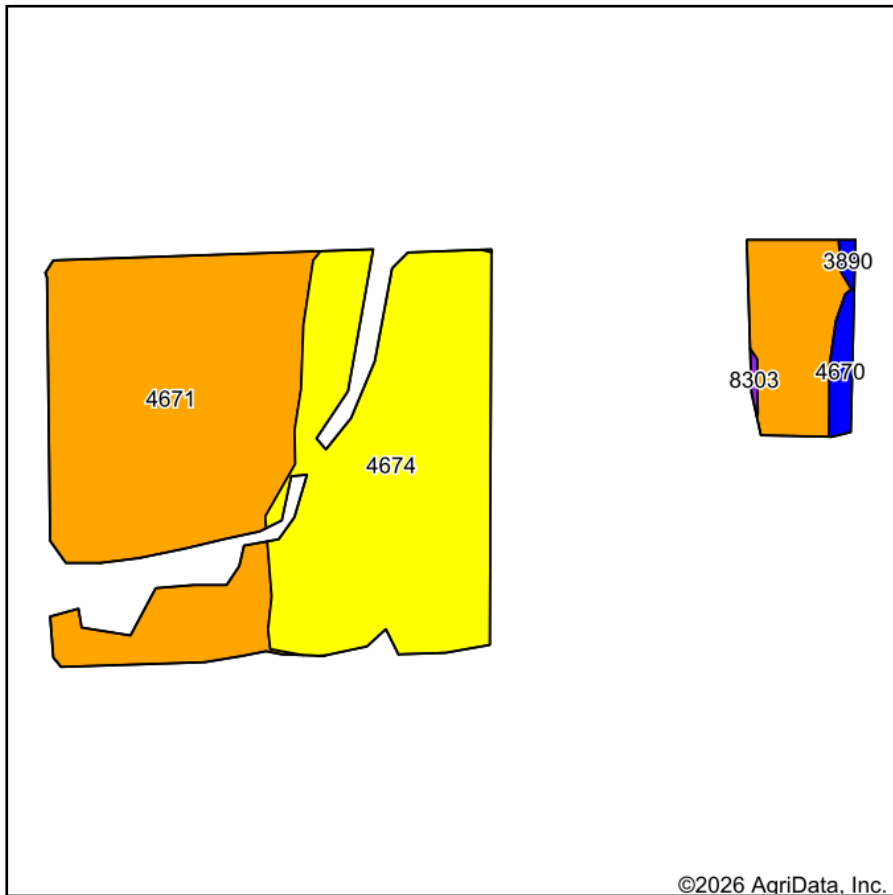

Soils data provided by USDA and NRCS.

Area Symbol: KS015, Soil Area Version: 23

Code	Soil Description	Acres	Percent of field	Non-Irr Class Legend	Non-Irr Class *c	Irr Class *c	Range Production (lbs/acre/yr)	*n NCCPI Overall	*n NCCPI Corn	*n NCCPI Small Grains	*n NCCPI Soybeans	*n NCCPI Cotton
4671	Irwin silty clay loam, 1 to 3 percent slopes	24.08	56.4%	[Orange]	III s	III s	3585	56	45	55	55	40
4674	Irwin silty clay loam, 3 to 7 percent slopes, eroded	17.70	41.5%	[Yellow]	IV e	IV e	3598	51	43	51	49	38
4670	Irwin silty clay loam, 0 to 1 percent slopes	0.66	1.5%	[Blue]	II s	II s	3600	60	51	59	60	43
3890	Ladysmith silty clay loam, 0 to 1 percent slopes	0.15	0.4%	[Blue]	II s	II s	3525	53	39	52	52	28
8303	Verdigris soils, frequently flooded	0.08	0.2%	[Purple]	V w		7725	61	61	51	56	14
<b>Weighted Average</b>					<b>3.40</b>	<b>*-</b>	<b>3598.2</b>	<b>*n 54</b>	<b>*n 44.3</b>	<b>*n 53.4</b>	<b>*n 52.6</b>	<b>*n 39.1</b>

\*n: The aggregation method is "Weighted Average using all components"

\*c: Using Capabilities Class Dominant Condition Aggregation Method

\*- Irr Class weighted average cannot be calculated on the current soils data due to missing data.